

New
SALT ROCK
City

Dolphin Ridge

Off plan home on erf 1039



UA
make space matter

INDLOVU
African Art

Interior**Edge**

MC
RICHMORE
VILLAGE ESTATE

General plan: Position of erf 1039

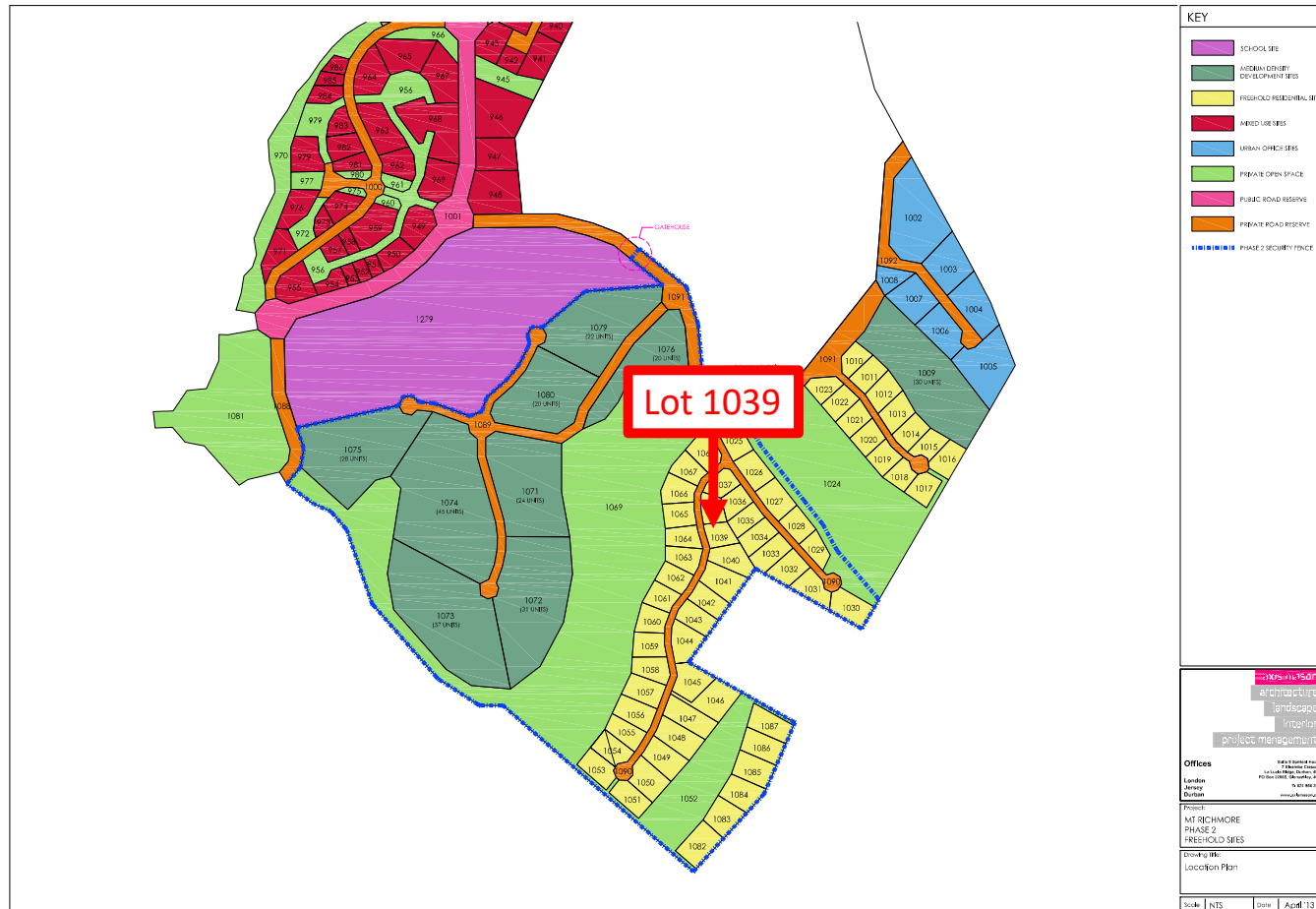

Aerial photo: Position of erf 1039



Front elevation



Back elevation



Site plan

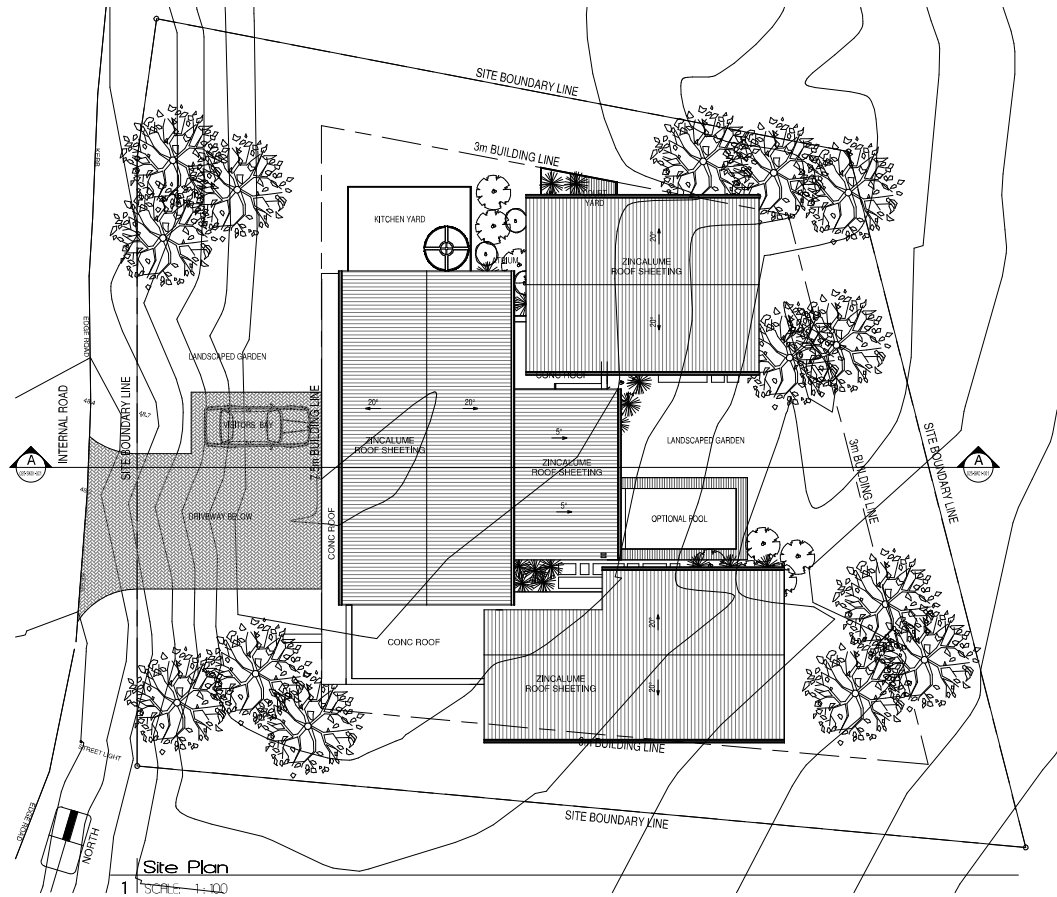

Layout: Ground floor



Layout: Basement

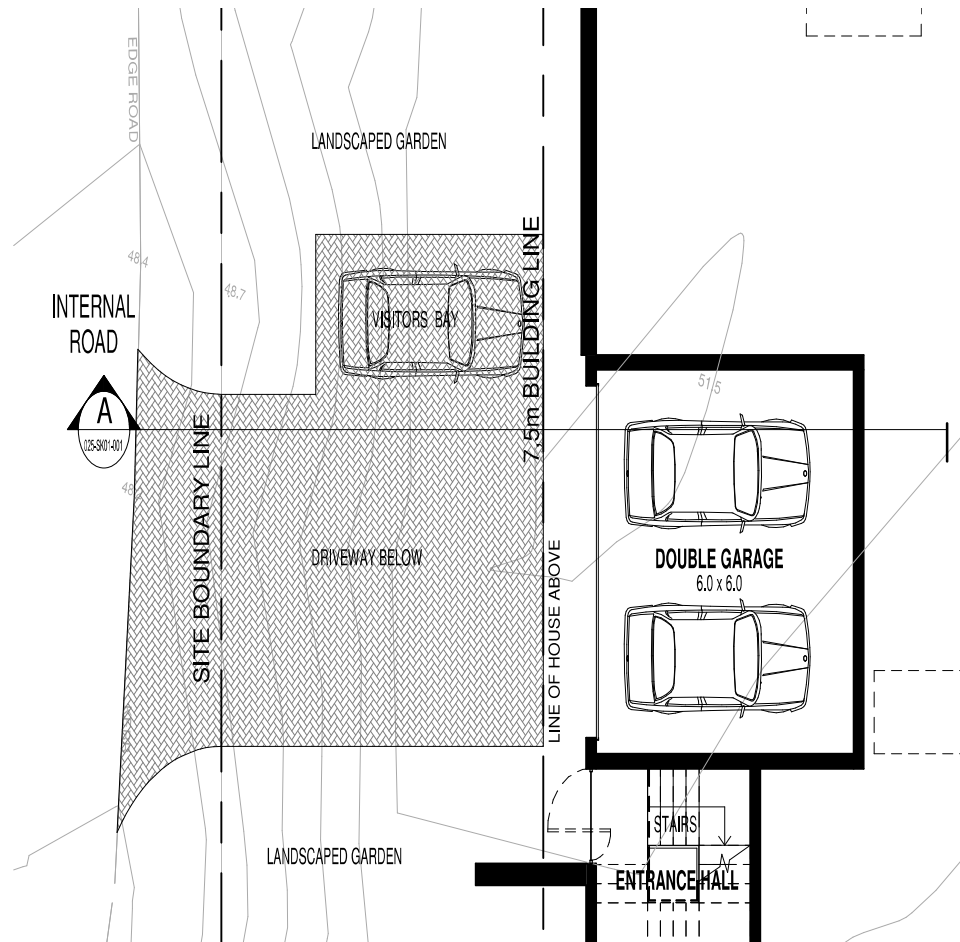

How a 'turnkey project' works

When building using the turnkey process, the **professional team manages and executes the entire project**, post land transfer to handing over the keys to a completed home, being based at a centrally based office allows the client **easy access** to the **entire team** throughout.

The professional team works together sharing and **integrating its knowledge base** with regards budgets, design, construction and management producing a final cost effective quality product.

Advantages of turnkey

- Experienced centrally located **professional team**
- **Cost effective** and timeous execution
- **Risk free**
- Legal, regulatory and financial **support**
- Guaranteed no **cost** overruns
- 5 year latent defect **guarantee**
- Reactive **maintenance** team
- Bank **approved**
- **Quality**

New
SALT ROCK
City

UA
make space matter



Interior**Edge**

M
RICHMORE
VILLAGE ESTATE

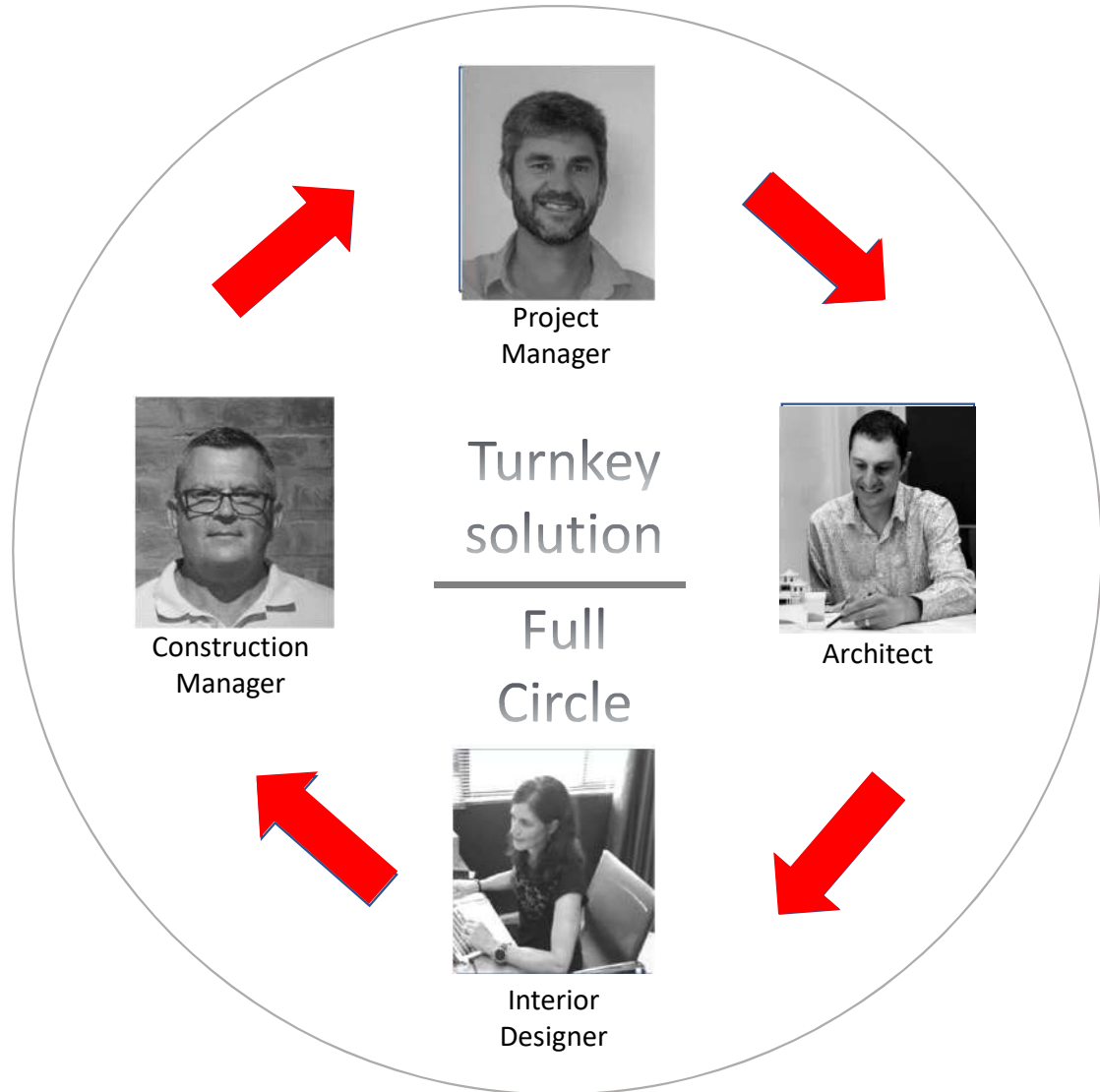

Concept



Concept



Concept



Concept



Concept



Concept



Concept



Concept



Concept



Concept





Mount Richmore Sales Team

Theo van As ☎071 879 6030

Warren Ellis ☎072 117 8655

www.newsaltrockcity.co.za